



Vinci Park

# MEASURE L BOND UPDATE

November 14, 2017

## Measure L – Overview

- Phase 2 Project Update
- Phase 3 Project Update
- Phase 4 Project Update
- Program Schedule Review

## Measure L – Phase 2 Projects

- Vinci Park Elementary School - FIS
  - Bid October 17, 2017, received 3 bids
  - Recommend award contract to Calstate Construction for \$634,888
  - Start construction November 2017
  - Completion March 2018
  - Exterior Canopy
    - Submit to CGS (California Geological Survey) November 2017
    - DSA December 2017
    - Purchase/install January/February 2018
- FIS Furniture – Vinci Park
  - Reviewing submittal with site
  - Order furniture by late November 2017
  - Furniture delivery mid March 2018
- Central Kitchen
  - The Punch list is approximately 96% completed. The Contractor will have the remainder of the punch list completed by the November 27, 2017.

## Measure L – Phase 3 Projects

- **Laneview Modernization Projects**
  - Punch List items – complete
  - Glazing (exterior glass replacement) - complete
- **Majestic Way Modernization Project**
  - Punch List items – complete
  - Glazing (exterior glass replacement) - complete
- **Ruskin Modernization Project**
  - Punch List items – complete
  - Glazing (exterior glass replacement) - complete
- **Piedmont Modernization Project**
  - Punch List items –complete
  - Glazing (exterior glass replacement) – TBD

## Measure L – Phase 3 Projects

- Modernization Projects
  - Moving
    - Contractor has replaced missing or damaged items
  - Furniture - Classroom
    - Vendor has completed punch list
  - Pavement Rehabilitation – Piedmont Middle School
    - District currently reviewing submittal
    - Submit to City & DSA for review December 2017
    - Bid early February 2018
    - Construction starts June 2018
    - This project will be presented to the Board at the December Board Meeting

## Measure L – Phase 3 Projects

- Laneview FIS Project - Work started October 30, 2017



## Measure L – Phase 3 Projects

- Majestic Way FIS Project - Work started October 30, 2017



## Measure L – Phase 3 Projects

- FIS Furniture - Vinci Park
  - Reviewing submittal with site
  - Order furniture by late November 2017
  - Furniture delivery mid February 2018
- FIS Furniture – Laneview & Majestic Way
  - Finalized order
  - Awaiting final quote
  - Order furniture by November 2017
  - Furniture delivery mid February 2018



## Measure L – Phase 4 Projects

- Modernization Projects
  - Ruskin Elementary School - FIS
    - Submit to DSA - November 27, 2017
  - Piedmont Middle School - FIS
    - Submit to DSA - November 13, 2017
  - Brooktree Elementary School
    - Submit to DSA - November 27, 2017
  - Cherrywood Elementary School
    - Submit to DSA - December 12, 2017
  - Toyon Elementary School
    - Submit to DSA - late December 2017
  - Morrill Middle School
    - Submit to DSA - November 27, 2017
  - AV @ MPR Elementary Schools
    - Installation of electrical requirement are complete
    - Installation of AV equipment by the end of November 2017



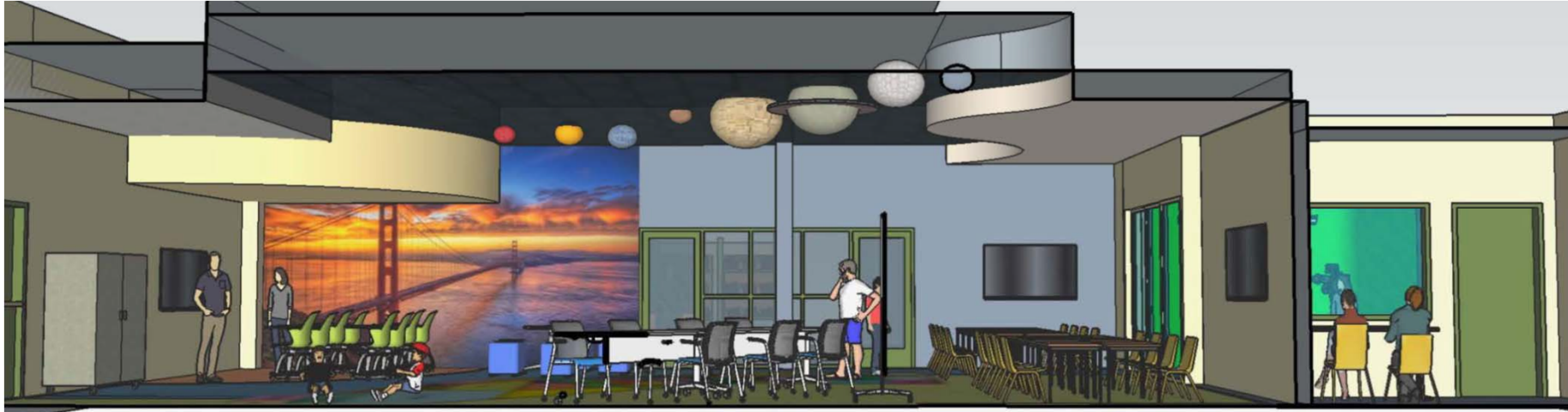

Vinci Park

Thank You